

# **New Multifunctional JP-Electric Retract controller V1 and V2**

## **Instruction Manual**



For JP Hobby Alloy Electric Retracts Landing Gear ER-005 / ER-010 / ER-120 / ER-150 / ER-200

### **A- Multi-function landing gear controller features:**

1. Automatic identification current
2. Set the voltage of the door servo
3. Set the CW and CCW direction and stroke of the door servo
4. Set the door retraction sequence

Long press the mode button to enter the setting mode:

1. When the A or B light is flashing, press the + / - button to set the servo CW and CCW direction function.
2. When A+B flashes alternately or C+D flashes alternately, press + / - button to set the stroke of the servo.
3. When the C lamp is flashing, it is V1 mode.
4. When the D lamp flashes, it is V2 mode.

**JP HOBBY is distributed in Europe by WEB EFFECT / TURBINES RC**

## New Multifunctional JP-Electric Retract controller V1 and V2

### Cinématique du séquenceur en mode V1

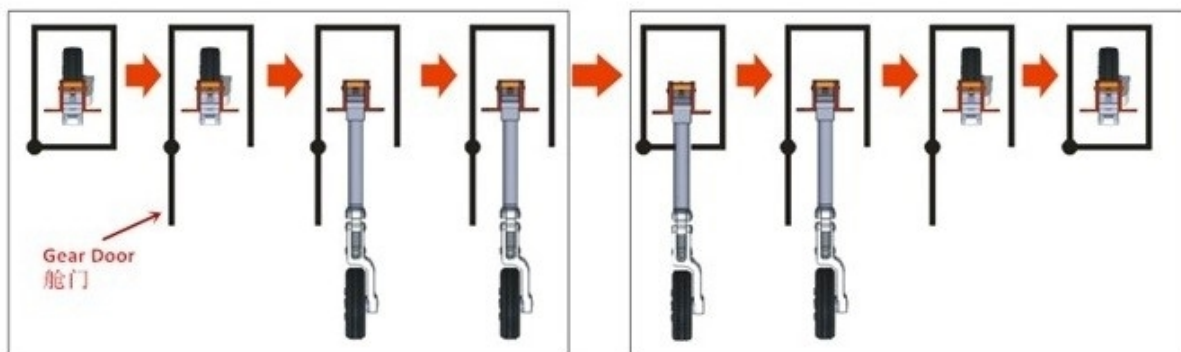

### Cinématique du séquenceur en mode V2

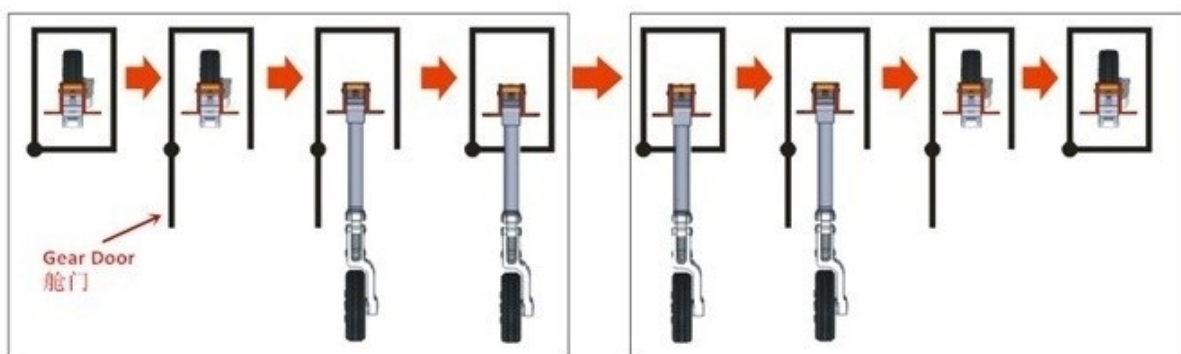

# New Multifunctional JP-Electric Retract controller V1 and V2

## B- Electric retract control operating principle:

In the normal service condition,

- Turn on the retract switch then the control system will activate the retraction system to open after checking the door fully open by Auto. The doors will close after the retract are open.
- Turn off the retract switch then the control system will activate the retraction system to close after checking the doors fully open by Auto. The doors will close again after the retract are close.

|                                 |                       |                     |                        |                                    |                       |                   |                        |
|---------------------------------|-----------------------|---------------------|------------------------|------------------------------------|-----------------------|-------------------|------------------------|
| Start the<br>Retract<br>channel | Gear door<br><br>OPEN | Retract<br><br>DOWN | Gear door<br><br>CLOSE | Shutted down<br>Retract<br>channel | Gear door<br><br>OPEN | Retract<br><br>UP | Gear door<br><br>CLOSE |
|---------------------------------|-----------------------|---------------------|------------------------|------------------------------------|-----------------------|-------------------|------------------------|

## C- Retracts installation, operation and maintenance

### Installation:

Installation is simple. The Retracts have a stander clamping and its installation is similar to any standard retract. An advantage of the electric retract is that installations of complex valves and air circuits are unnecessary. The Retracts are supplied with long enough cable which is directly connected to the control unit. If the cable is no long enough, it can be extended with the correct polarity. Is advisable prolong just the necessary length to avoid voltage drops.

### Operation:

Retracts must be operated always through JP Retract Control units. Never operate the retracts with direct battery or with other brands control units. The best quality of electric retracts. You will notice the advantage of not having to compress air before each flight, and you will forget the leaks.

## New Multifunctional JP-Electric Retract controller V1 and V2

Retracts Trouble shooting:

| Problems  | Solutions   |  |
|---|---|--|
| <b>The Retract doesn't move</b>                           | Check whether the retract controller signal lines connected correctly                     | The retract controller signal lines connected to the retract channel again |
|   | Check whether the remote control signal is normal   | Check the switch channels. Good debugging remote control signal            |
|   | Check whether the remote control retract channel release percentage is set to $\pm 100\%$ | sure the release percentage is set to $\pm 100\%$                          |
|   | Check whether the 6V power supply is to run out of electricity                            | 6V battery charged   |
| <b>The gear door doesn't open</b>                         | Check whether doors servo signal lines connected correctly                                | Please follow the labeled correctly connected in the controller            |
|   | Check whether door servo damage   | Change the door servo  |
|   | Check whether three units retract are connected to the retract controller                 | Please connect three units retract to the control system                   |
| <b>The gear door run is in wrong direction</b>            | Please check the doors servo signal lines connected to the right channel                  | Change the doors servo signal lines from wrong channel to other one        |
| <b>Three units retract not work in the same direction</b> | Check the retract cable is correct  | Reverse running horse cables properly connected to the controll            |

**JP HOBBY is distributed in Europe by WEB EFFECT / TURBINES RC**